

# JAMOR

Eixo verde e azul  
*Green and Blue Axis*





1. Starting point
  - a. Urban territory
  - b. Population
2. Urban Rehabilitation Strategy
  - a. Municipal's nature based solutions
  - b. ARU (urban rehabilitation area)
  - c. Intermunicipal project
3. Project's principles
  - a. The project
  - b. Phasing
  - c. Investment
  - d. Results
4. Next steps

## City Policy

- Centrality
- Identity
- Attractiveness of economic activities
- Recreation areas
- Requalification of public space

## Environmental Policy

- Requalification of public space
- Resilience of natural systems
- Urban decompression areas
- Ecosystem services

# Municipal Policy





**Revitalization of the city center** and village, on the rehabilitation of **public spaces**, the enhancement of free areas and rehabilitation of the building.

The **enhancement of the Jamor River**, a **linear, pedestrian and cycling link between the two villages** (Queluz-Belas) and as a strategic intervention to improve the quality of urban space.

The qualification of public space will enhance Queluz and the village of Belas, enhancing synergies that **induce local economic dynamism** and creating social and cultural vitality.

The requalification of streams as a natural space becomes a potential for integration into urban space and contributes to the improvement of the population's quality of life.

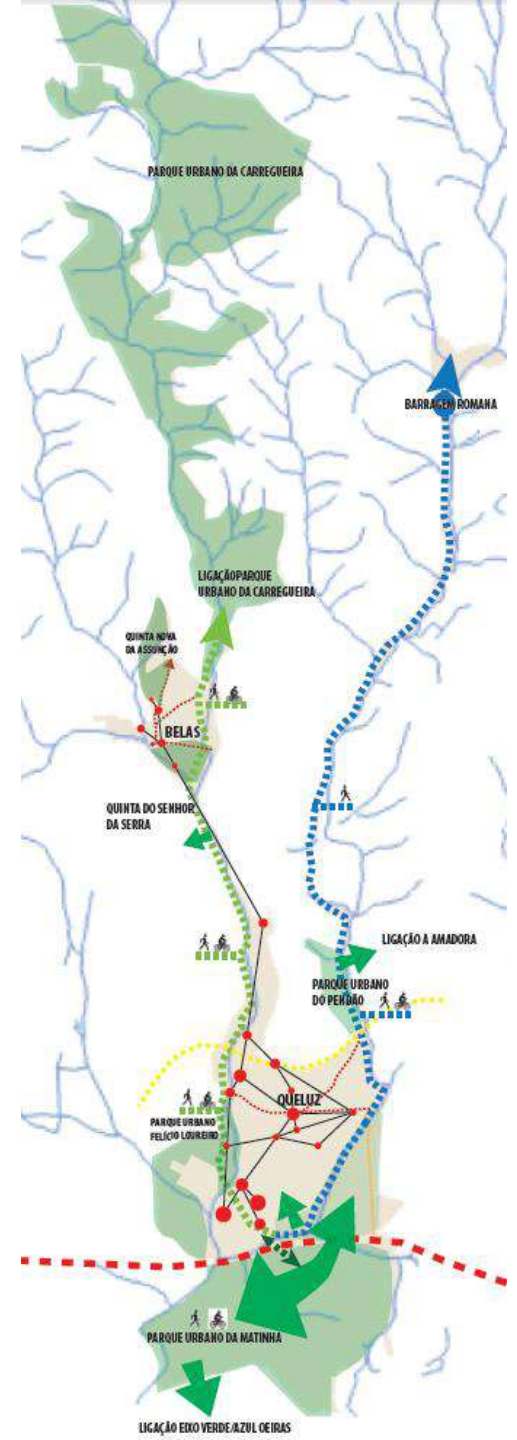

# Demography and built park

Classic Buildings – Construction Time

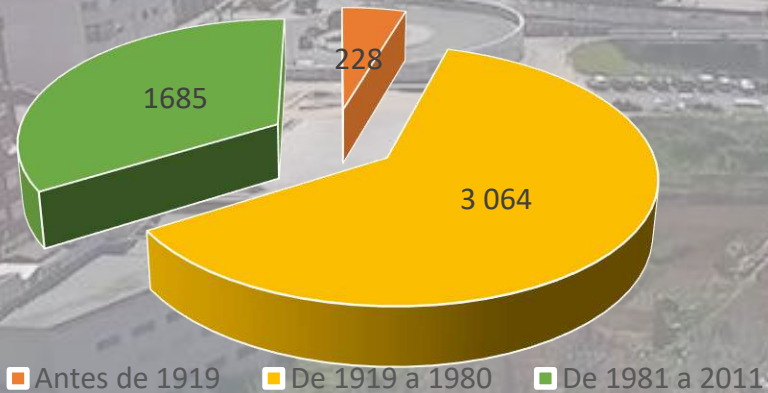

Indexes	ARU Queluz- Belas	Município de Sintra
Aging Index	97	78
Elderly Dependency Ratio	24	20
Youth Dependency Ratio	25	26
Total Dependency Ratio	48	46
Resident Individuals(2018)	61.338	388.434



## Environmental impact on the relationship between the natural and the human systems

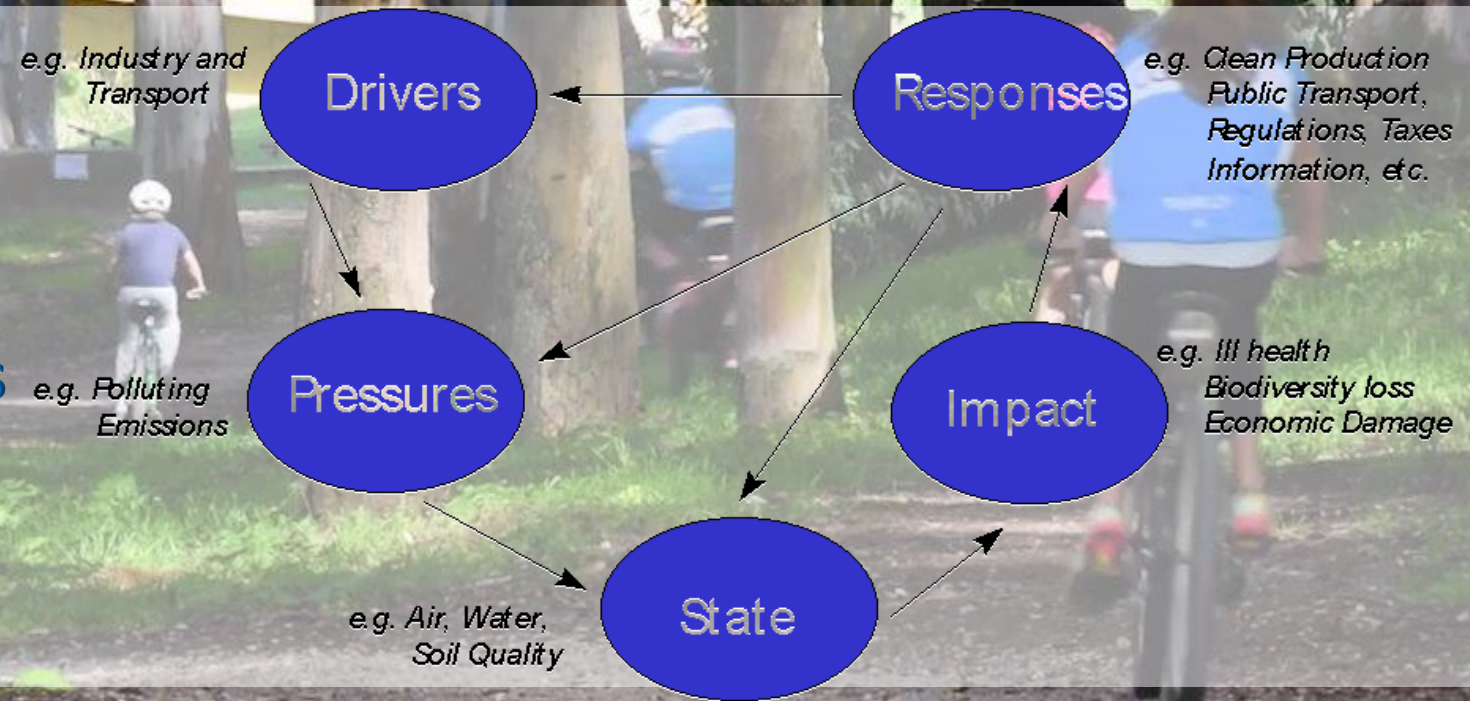

Modelo DPSIR. Fonte: Agência Europeia do Ambiente

# Essential Concepts of the Proposal:

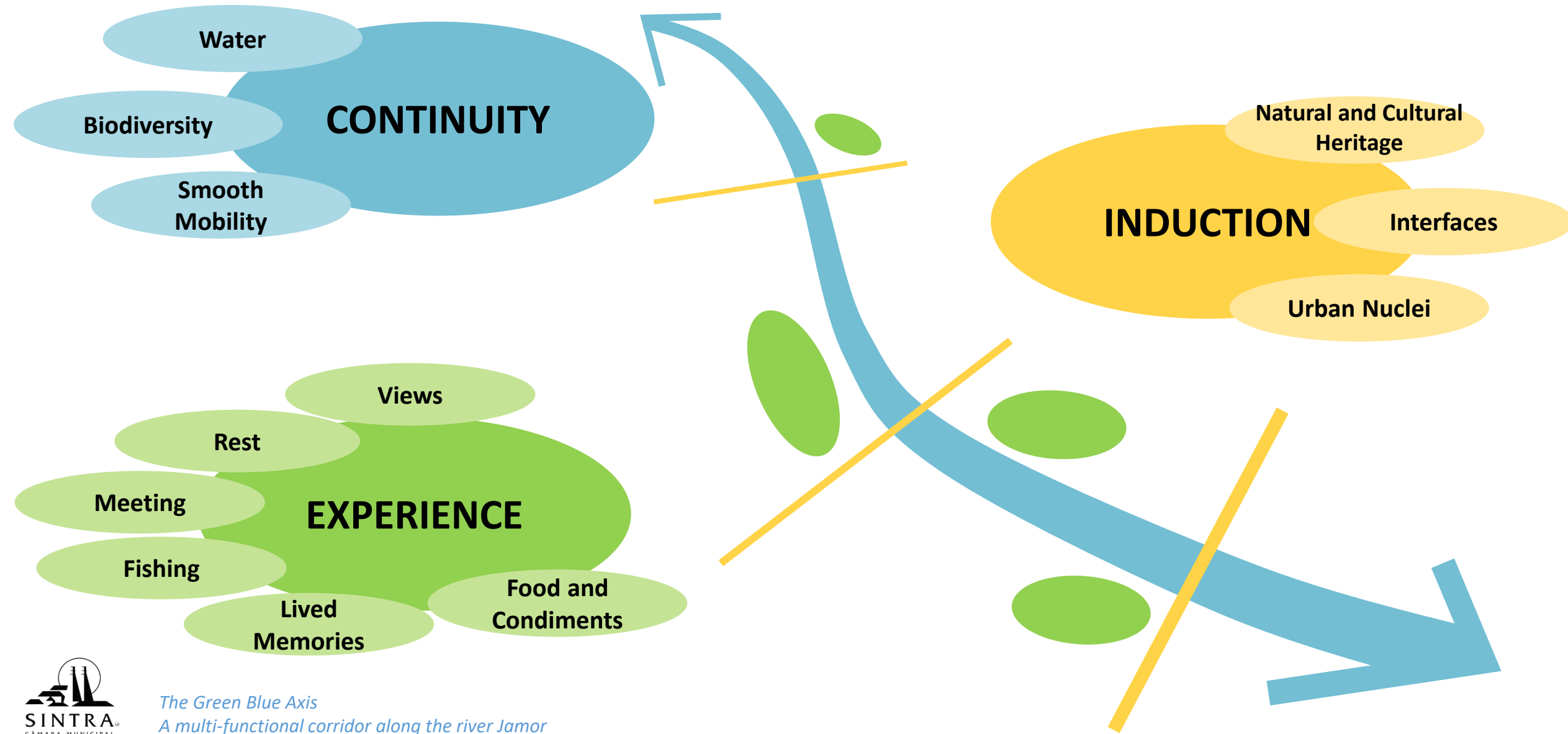



## HIDROGRAPHY



## MUNICIPALITIES



## FREEWAYS AND RAILROADS

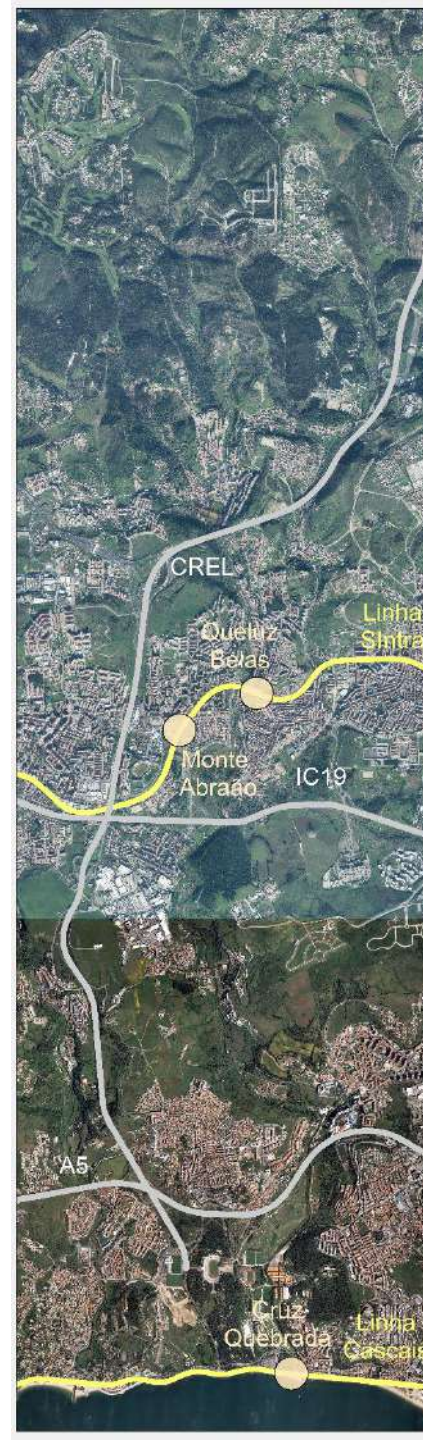



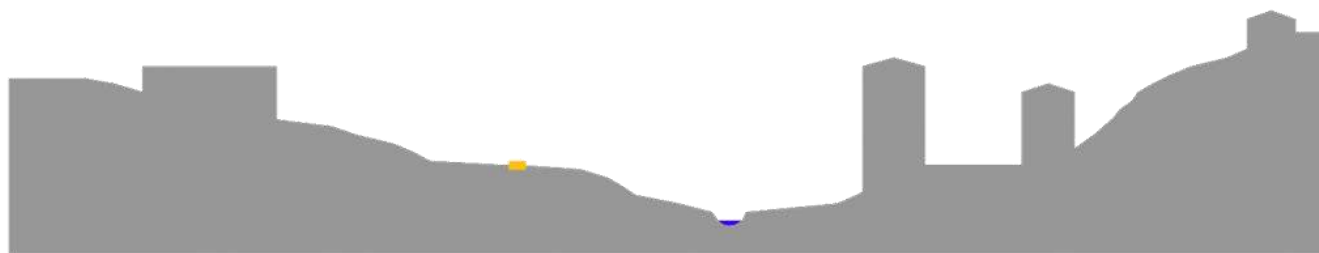
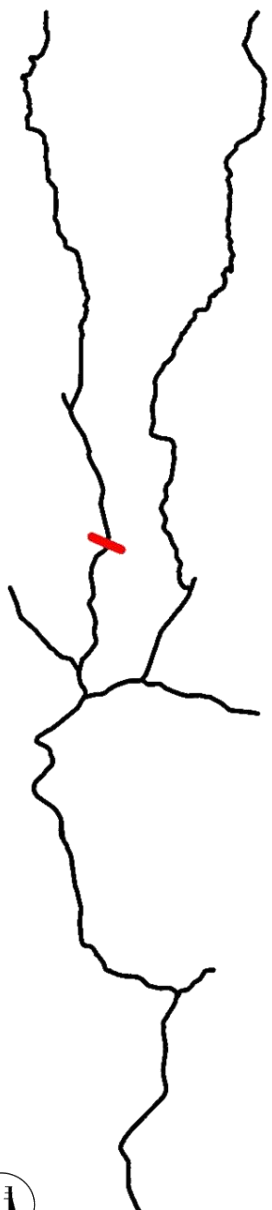







# BIOPHYSICAL VALUATION

- . Cleaning the streambed
- . Weed eradication
- . Riparian gallery introduction
- . Increased self-cleaning capacity of water lines
- . Habitat improvement for priority species

















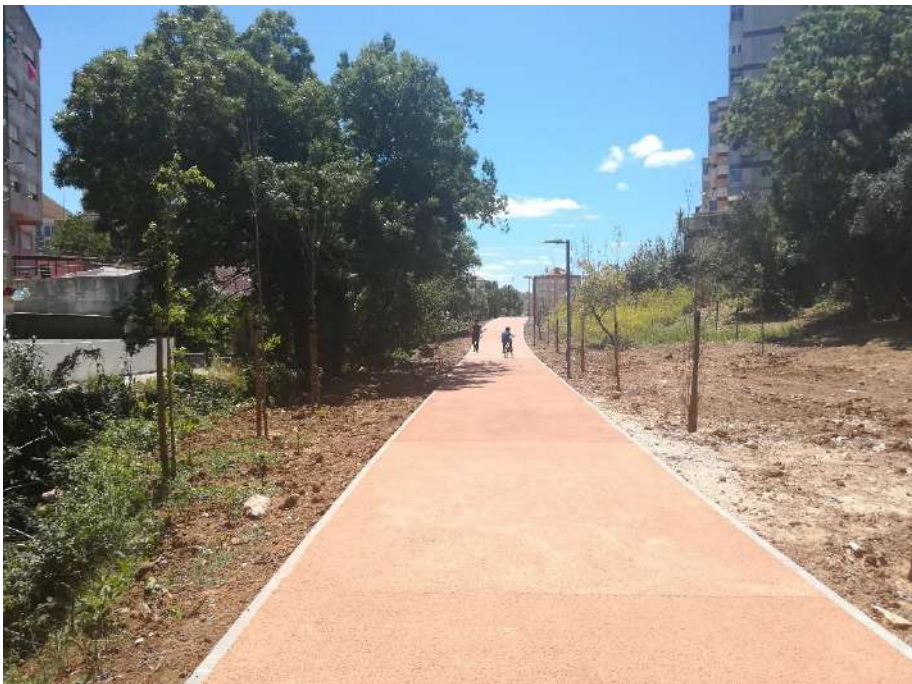







## New green spaces (ha):

Existing	New	Total
50,3	43,4	93,7

86% increase in green area equipped and formally open to the public, surrounding the Queluz Nacional Palace

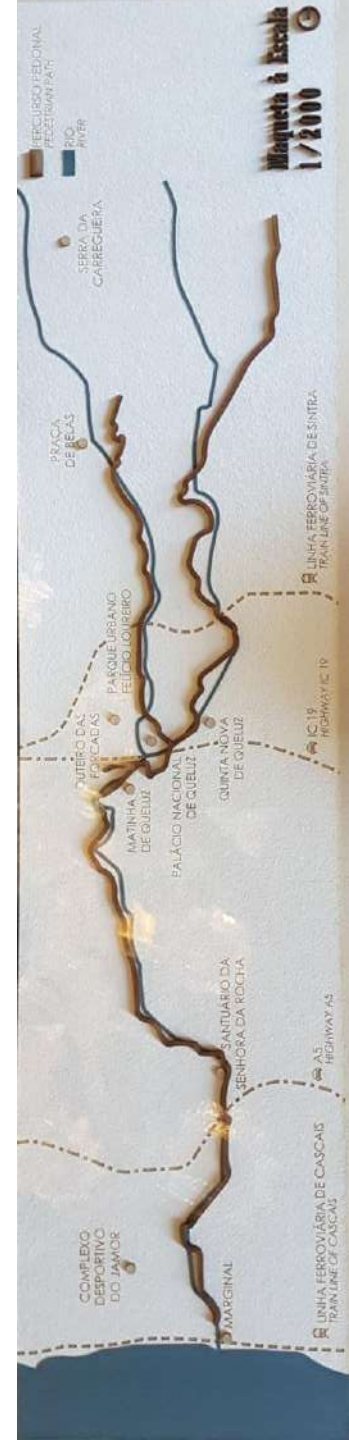



# STRUCTURING PROJECTS

## LANDSCAPE AND ENVIRONMENTAL ENHANCEMENT OF JAMOR RIVER

### New routes (ml):

Sintra	Oeiras	total
7.350	7.450	14.800

### Treated water lines (ml):

Sintra	Oeiras	total
7.250	6.850	14.100

(Note: Oeiras, includes Complexo Desportivo do Jamor)

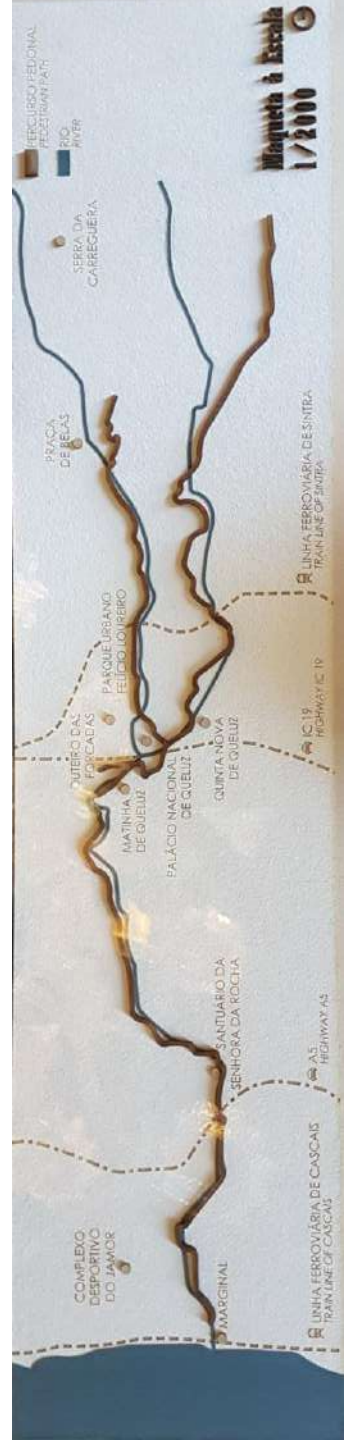



# Solidarity gardens





# Serra da Carregueira Municipal Forest Park



- 1 Parqueamento automóvel
- 2 Entrada Sul
- 3 Desporto equestre
- 4 Futuro campo de futebol do Belas Clube de Campo
- 5 Mirante do marco geodésico
- Limite do Parque da Serra da Carregueira
- Caminhos
- Trilhos
- Linhas de água
- Leito de cheia
- Charcos/Lagunas de retenção
- Açudes
- Matacões arbóreos
- Clareiras



# Queluz Green bridge

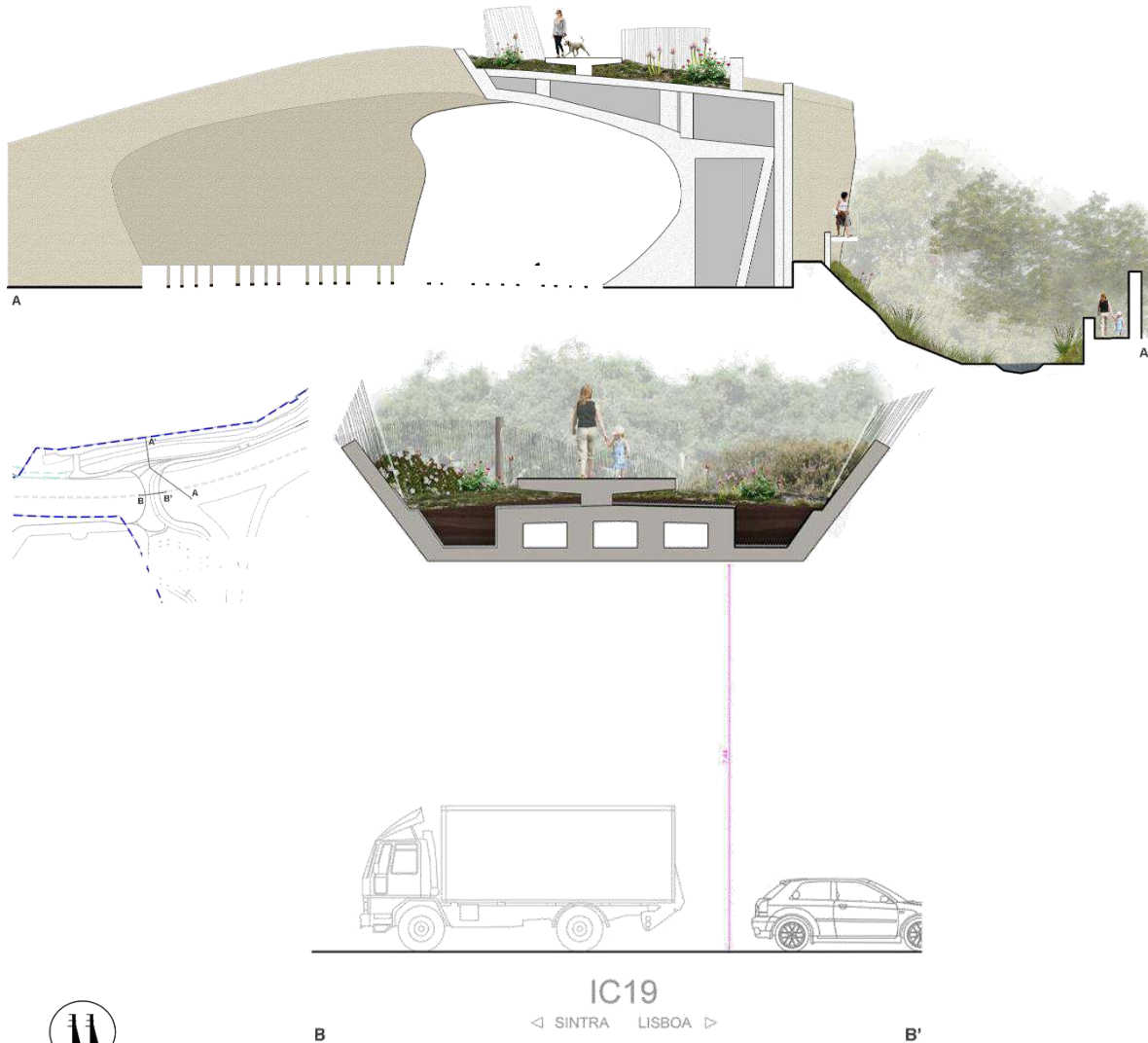



## Retention basin

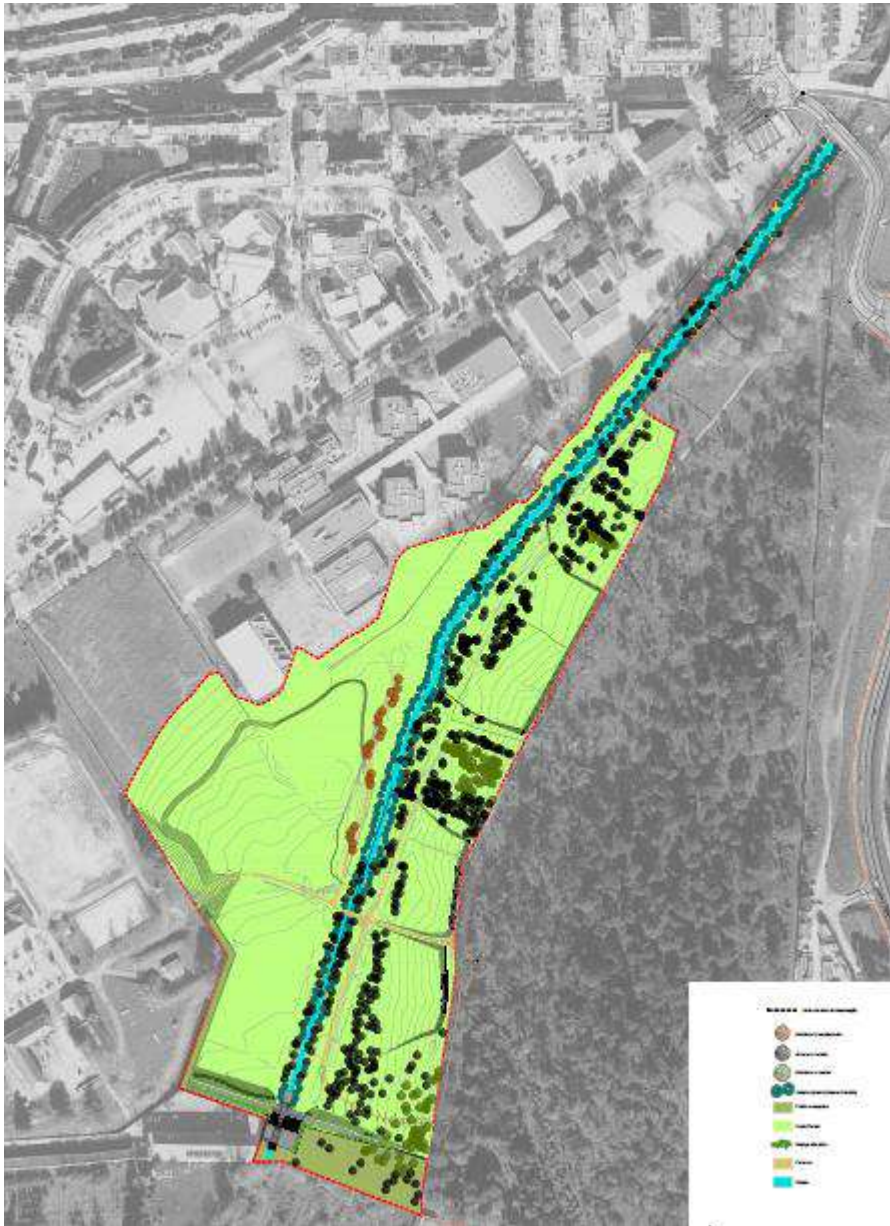



## Requalification of the Queluz National Palace Yard

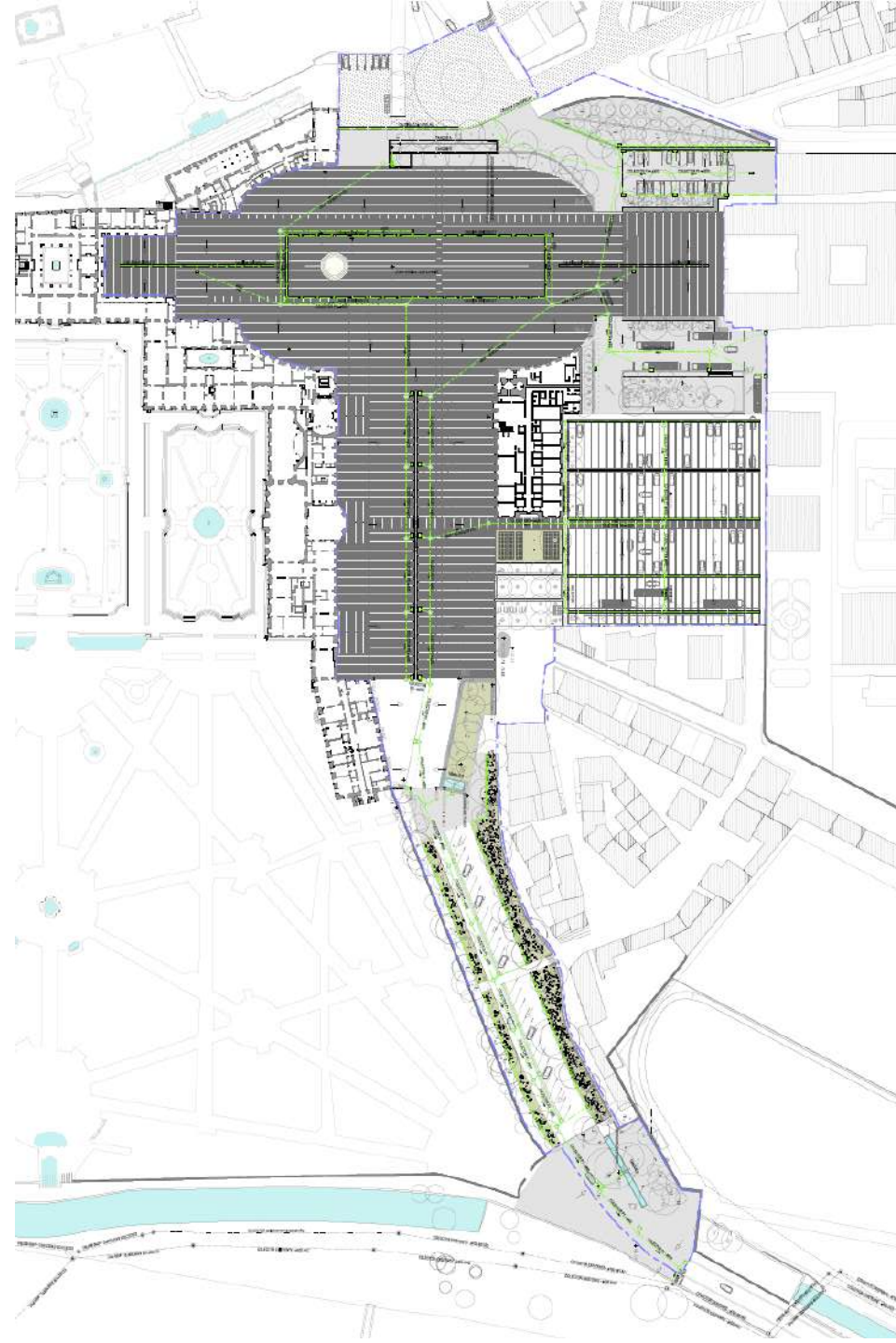



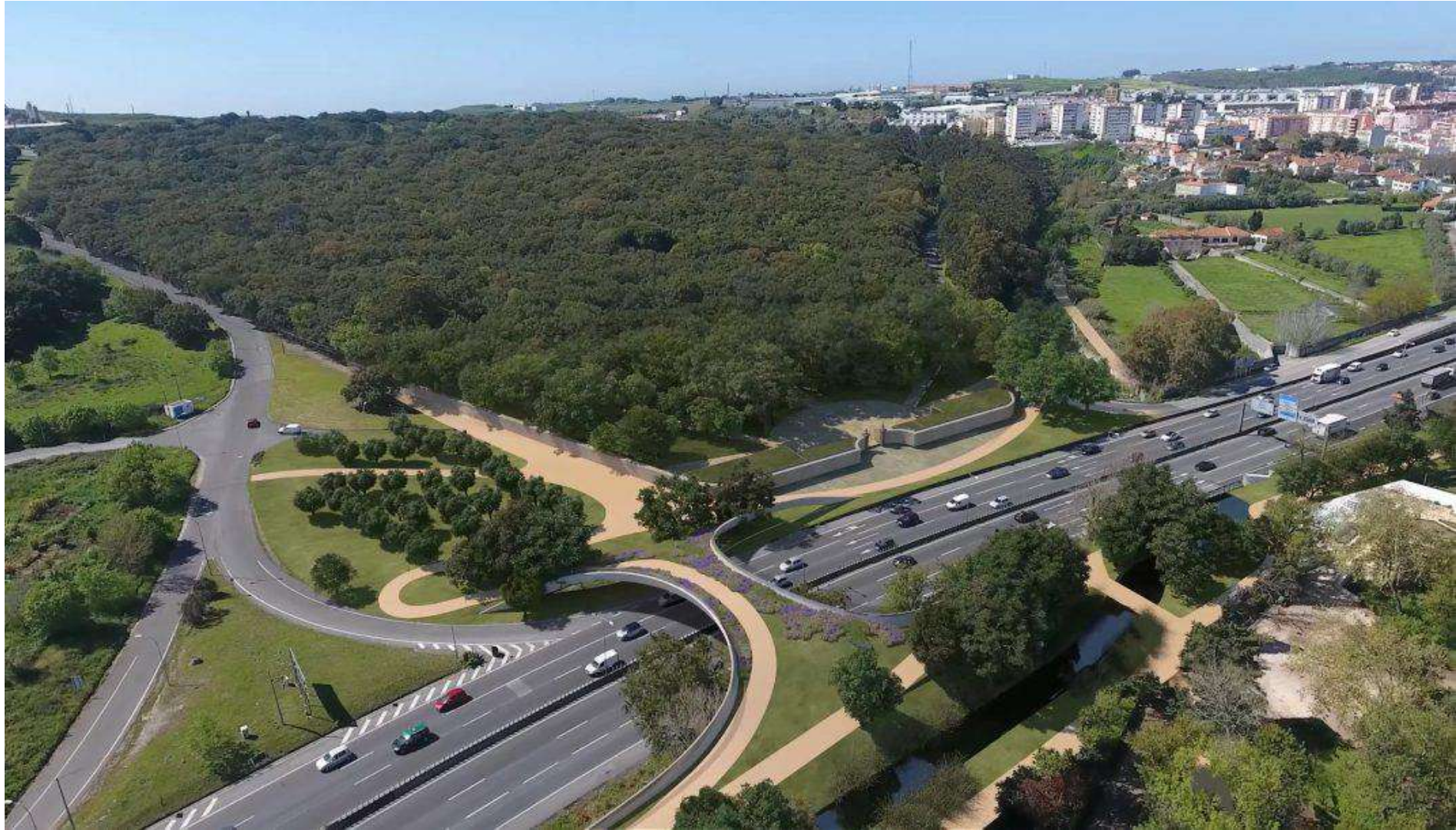

# Queluz's Woods



BIODESIGN, Ambiente e Paisagem, Lda.



Project phases	Investment	FEDER
EVA (1st phase)	€ 1 739 627,79	€ 869 813,90   
Solidarity gardens	€ 300 000,00	(application)
Serra da Carregueira Municipal Forest Park (1st phase)	€ 2 400 000,00	
Green bridge	€ 3 812 019,16	
Retention basin	€ 1 200 000,00	
Requalification of the Queluz National Palace Yard	€ 3 846 254,00	
Queluz's Woods	€ 2 000 000,00	

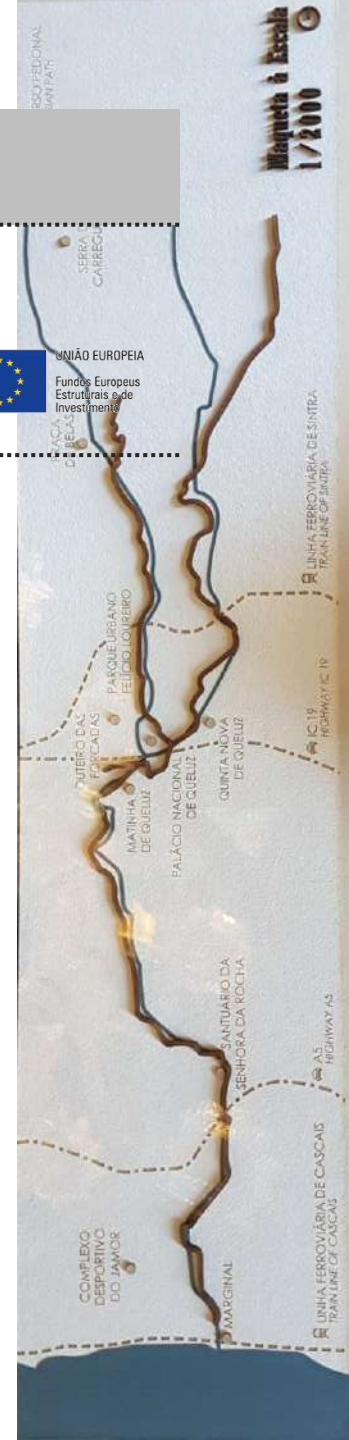



# JAMOR

Eixo verde e azul  
*Green and Blue Axis*